

- GENERAL NOTES**
1. THIS IS A DEVELOPMENT PLAN TO BE PROGRESSIVELY IMPLEMENTED AS AREA IS EXCAVATED, BUT NO PUBLIC ACCESS IS TO BE PERMITTED UNTIL SITE WORK IS FINISHED.
 2. ALL STRIPPING MATERIAL WILL BE LEVELED AND ORIGINAL CONTOURS ESTABLISHED. AFFECTED SURFACE AREA TO BE REVEGETATED IN ACCORDANCE TO THE STATE OF ILLINOIS RECLAMATION LAWS

- LEGEND**
- 600 EXISTING ELEVATION
 - 600- PROPOSED CONTOURS
 - ☁ PLANTING
 - x-x- FENCING

EXHIBIT "C"

VULCAN MATERIALS COMPANY			
SCALE 1"=100'	DATE 9-14-97	REV: 10-18-85	REV: 6-12-92 J.F.
DESIGN	CHECKED	REV:	REV:
DRAWN	APPROVED	REV:	REV:

THIS DRAWING IN DESIGN AND DETAIL IS THE PROPERTY OF VULCAN MATERIALS COMPANY AND MUST BE RETURNED UPON DEMAND. THIS DRAWING MUST NOT BE COPIED, REPRODUCED OR USED WITHOUT PERMISSION.

TITLE: PROPOSED DEVELOPMENT PLAN
LEGATON-ARNOLD PROPERTY

WORK ORDER:

DIVISION MIDWEST

PLANT

DRWG. NO. 102-88-6-0-23

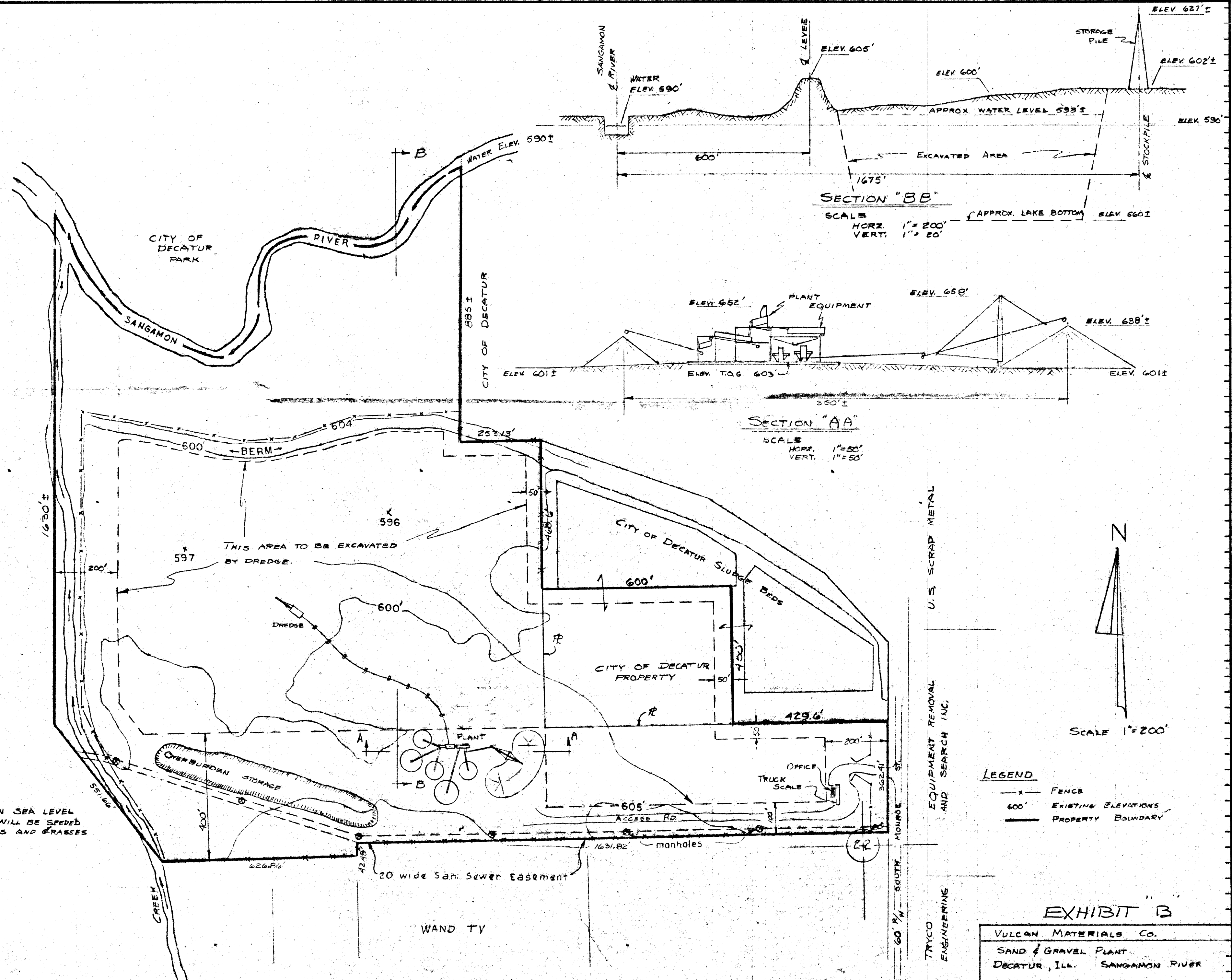

- NOTES**
- 1) DATUM USCGS MEAN SEA LEVEL
 - 2) DISTURBED SURFACES WILL BE SEEDED WITH SUITABLE LEGUMES AND GRASSES

VULCAN MATERIALS COMPANY

DIV: MIDWEST		PLANT: DECATUR #404	
DRAWN: R.W./J.C.	CHECKED:	REV: 8/25/87 X2	REV: C.F. 9-16-87
TRACED:	APPROVED:	REV: 8/27/87 X2	REV: 10-13-87 C.F.
		REV: 10-21-87 (600' x 400') C.F.	REV: 11-3-87 C.F.
		REV: 6-10-92 OFFICE / SHOP C.F.	

THIS DRAWING IN DESIGN AND DETAIL IS THE PROPERTY OF VULCAN MATERIALS COMPANY AND MUST BE RETURNED UPON DEMAND. THIS DRAWING MUST NOT BE COPIED, REPRODUCED OR USED WITHOUT PERMISSION.

TITLE: DECATUR - ARNOLD PROPERTY - PLANT LAYOUT

WORK ORDER:

DATE: JUNE 16, 1987
 SCALE: 1" = 200'
 PRINT ISSUED:
 DRWG. NO. C-305-A-2
 SHEET OF

EXHIBIT B

VULCAN MATERIALS CO.
 SAND & GRAVEL PLANT
 DECATUR, ILL. SANGAMON RIVER